



M8

INFORMATION GUIDE

M8

©2020 Balboa Water Group. Single Source Solution. All rights reserved.
3030 Airway Avenue | Costa Mesa, CA 92626 | p 714.384.0384 | www.balboawater.com
Specifications subject to change without notice.

BALBOA
water group

How can I get M8 to work to maximum effect?

Keep the cover on the spa. With the spa uncovered, the further the Set Temperature is above the ambient temperature, the less M8 will have a chance to be effective. M8 is only likely to be effective with the spa uncovered if the Set Temperature is at or below the ambient temperature.

What are the benefits of M8?

It may improve the life of the pump, if the pump does indeed get to run way fewer times each day.

In some cases, it may reduce the noise that some customers complain about, if they hear noise every time the pump runs.

Does M8 save energy?

In cases where no heating is needed at all (or where the heating source is external to the BP, and the BP heater is not used), then M8 may save a modest amount of energy (compared to M8 being disabled).

But in a situation where heating is needed to maintain the temperature, even with the spa cover on, the energy savings from M8 are likely to be completely dwarfed by the energy usage from the heater itself. In tests that some customers have done, increasing the polling interval had no consistent measurable effect on total energy usage when the spa had to maintain temperature, and that's because the heater energy usage is so overwhelming, any small reduction in usage of the pump by comparison is "in the noise" of energy readings. Also, in some spas the pump itself adds a little bit of heat, so in those cases running the pump less might require running the heater a bit more often or a bit longer, and that may offset the energy savings from less pump run.

How does M8 work?

- M8 works when the system pack is in Ready mode. Ready mode keeps the water temperature equal to or close to the set temperature.
- Each periodic check of the water temperature is called a "Poll".
- M8 polls every 30, 60, 90 or 120 minutes. These time intervals are called "M8 Cycle Times".
- 120 minute cycle times can save energy and may prolong the life of the pump.
- If the water temperature is stable enough, the M8 Cycle Time will reach 120 minutes.
- If the water temperature drops significantly enough, the M8 Cycle Time may eventually drop to 30 minutes.
- If the user interacts with the panel, the M8 Cycle Time is likely to be reset to 30 minutes.

**M8 Cycle Times:
30, 60, 90 or 120 minutes.**



*BP System Pack
Software Version: 43.0 (or above)*

M8

©2020 Balboa Water Group. Single Source Solution. All rights reserved.
3030 Airway Avenue | Costa Mesa, CA 92626 | p 714.384.0384 | www.balboawater.com
Specifications subject to change without notice.

Why do dashes appear in panel display instead of the water temperature?

Dashes appear (A) (B) when the water temperature has not been measured for more than an hour. Dashes also indicate that the water temperature is stable. Dashes are normal and they do not indicate an error.

M8 can increase the time between polls (ie, the time between water temperature measurements) to 90 or 120 minutes, and in those cases it's normal to see dashes once it's been over an hour since the last poll. It does not mean anything is wrong; in fact, it tells you that M8 has detected stable water temperatures (which is good from an energy saving standpoint), and that's why M8 has increased the time between polls to 90 or 120 minutes.

The only other indication of whether M8 has increased the time between polls is on the *System Information* screen (as described in the section entitled "How can I see the M8 Cycle Time" on pages 7 and 8), on spaTouch™ panels only.

Dashes appear temporarily at system startup. Once the water temperature has been determined, dashes are replaced with the water temperature.

spaTouch™ 3 Home Screen

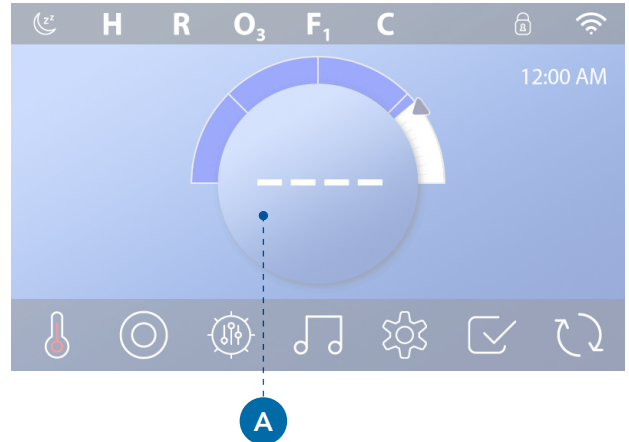

spaTouch™ 2 Home Screen

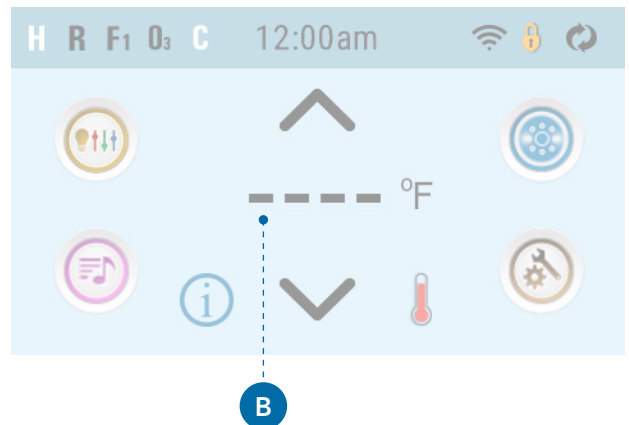

Does my system have M8? (spaTouch™ 1 & 2)

M8 is implemented on any BP system with software version 43.0 or later. Your BP system's software version can be found on the spaTouch™ panel or the front page of the system's technical documentation.

To view the system software version on the spaTouch™ panel, go to the *Home* screen (A), and navigate to the *System Information* screen (B). The software version is here (C).

For other panels, consult the panel *User Guide* to see how to get to the *Information / INFO* menu.



spaTouch™ 2 Panel

Note: The spaTouch™ 1 (icon) and spaTouch™ 2 user interfaces are almost identical.

In this example the version is 43.0, so it supports M8.

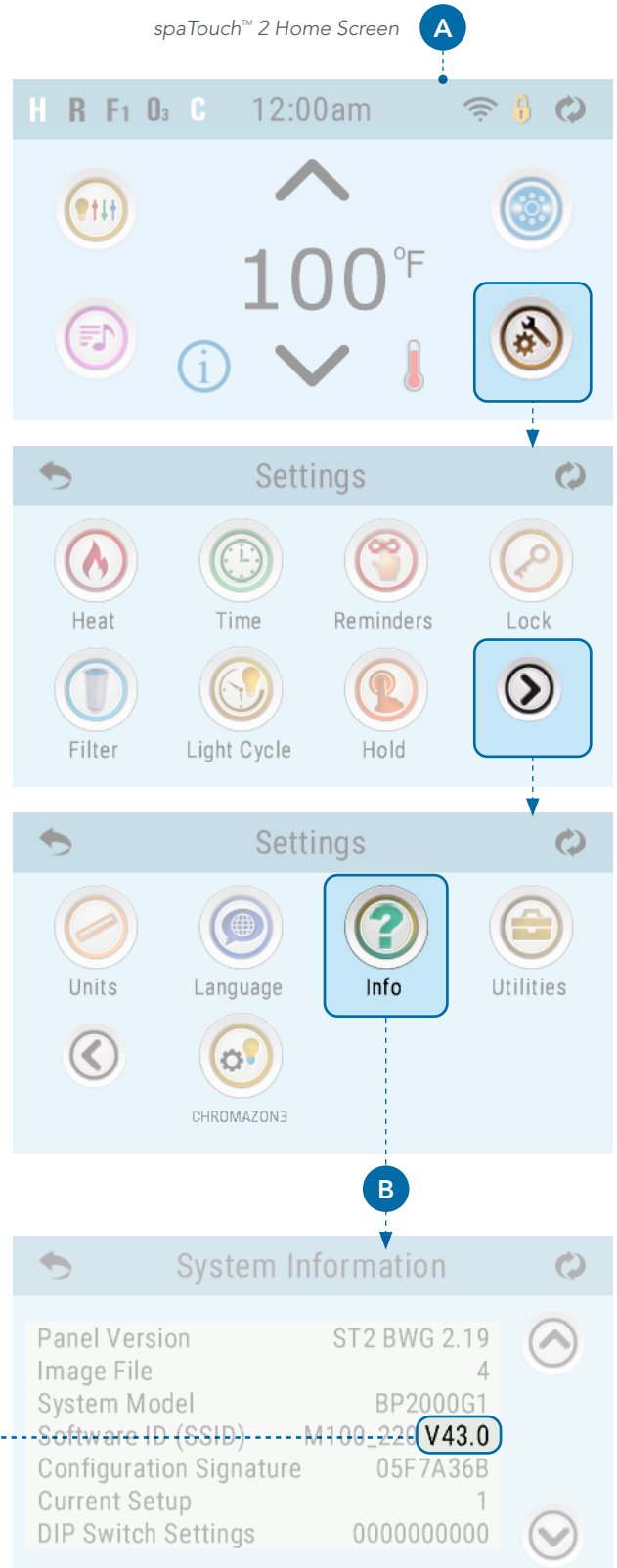

Does my system have M8? (spaTouch™ 3)

M8 is implemented on any BP system with software version 43.0 or later. Your BP system's software version can be found on the spaTouch™ panel or the front page of the system's technical documentation.

To view the system software version on the spaTouch™ panel, go to the *Home* screen (A), and navigate to the *System Information* screen (B). The software version is here (C).

For other panels, consult the panel *User Guide* to see how to get to the *Information / INFO* menu.



spaTouch™ 3 Panel

spaTouch™ 3 Home Screen

Settings

Diagnostics

System Information

Panel Version	ST3 BWG 1.02	▲
System Model	BP2000G1	
Software ID (SSID)	M100_225 V43.0	
Configuration Signature	D22BE239	
Current Setup	9	
DIP Switch Settings	1000010000	▼
Heater Wattage	3-6 kW	
Heater Type	7	

In this example the version is 43.0, so it supports M8.

M8

©2020 Balboa Water Group. Single Source Solution. All rights reserved.
3030 Airway Avenue | Costa Mesa, CA 92626 | p 714.384.0384 | www.balboawater.com
Specifications subject to change without notice.

Does my system have M8?

(Continued)

Your BP system's software version is noted on the front page of the system's technical documentation (A).

Front page of technical document

BP501G1 Tech Sheet

Customer: Balboa Water Group

Part Number:

56485-06	5.5kW 800 Incoloy
56486-06	5.5kW 825 Incoloy
56487-06	5.5kW Titanium
56567-05	4.0kW 800 Incoloy

Custom Box Overlay

Box Overlay Part Number N/A

UL System Model For 5.5kW: BP501-BP501G1-BU

UL System Model For 4.0kW: BP501-BP501G1-BS

Software Version ID: M100_201 V44.0

Software Version: 44.0

File Name: BP501_44.0_BP501G1

Configuration Signature: E807947A

Eng. Project Number: 5264

Control Panels (See later pages for more information):

spaTouch™ 2 Any version (version 2.0 or later required)

Icon spaTouch™ Any version (version 3.36 or later required)

Menued spaTouch™ Any version (version 2.8 or later required)

TP900 Version 3.1 and later (Version 3.13 or later required)

TP800 Version 3.1 and later (Version 3.13 or later required)

TP600 Version 2.7 and later (Version 2.12 or later required)

TP400T US Version 2.7 and later (TP400T CE may be used)

In this example the version is 44.0, so it supports M8.

M8

©2020 Balboa Water Group. Single Source Solution. All rights reserved.
3030 Airway Avenue | Costa Mesa, CA 92626 | p 714.384.0384 | www.balboawater.com
Specifications subject to change without notice.

How can I see the M8 Cycle Time? (spaTouch™ 1 & 2)

Go to the *Home* screen (A) on the spaTouch™ panel, and navigate to the *System Information* screen (B) to view the *M8 Cycle Time* (C). Press the Up/Down buttons (D) to scroll the System Information list. If M8 is turned Off, the *M8 Cycle Time* says "Disabled" on the System Information screen, and is always 30 minutes. If M8 is turned On, the *M8 Cycle Time* will be one of the following durations: 30, 60, 90 or 120 minutes. It will display as "--" if the M8 Cycle Time is not applicable (for example, in Rest Mode).

M8 Cycle Time does not appear on non-spaTouch™ panels.

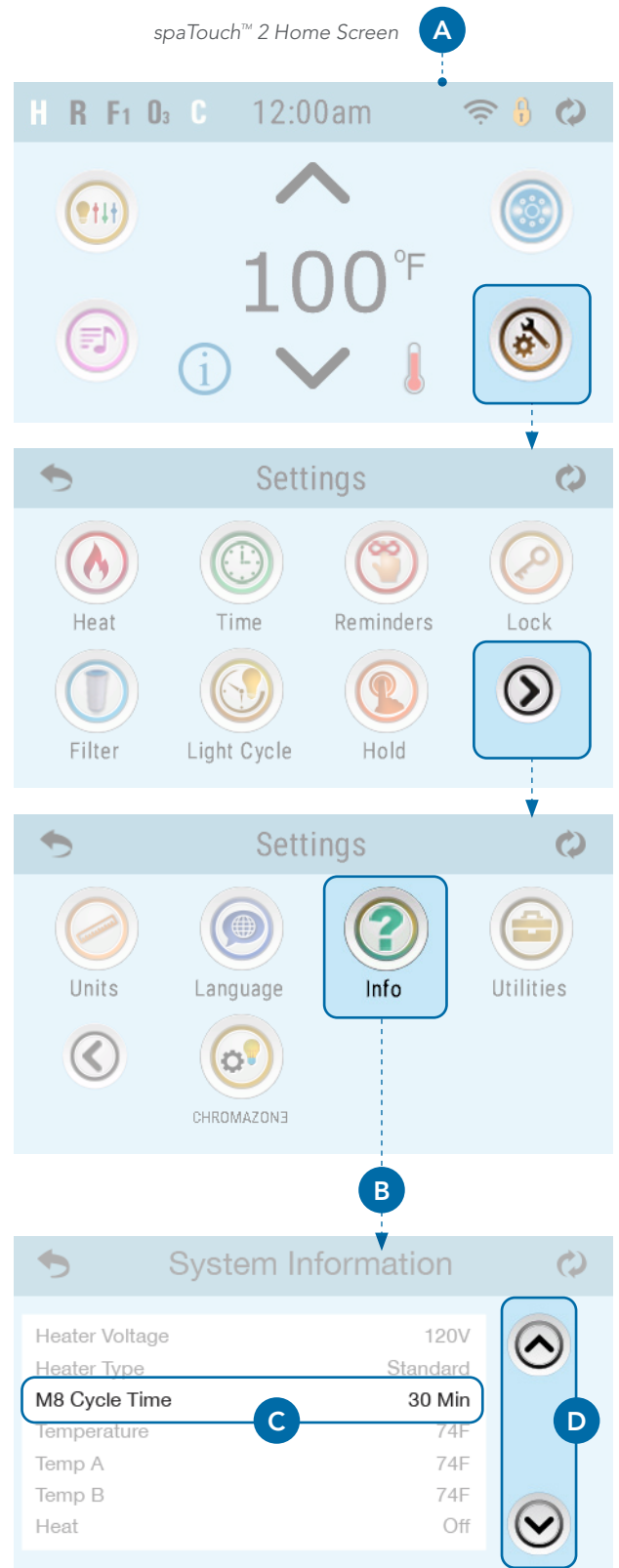

M8

©2020 Balboa Water Group. Single Source Solution. All rights reserved.
3030 Airway Avenue | Costa Mesa, CA 92626 | p 714.384.0384 | www.balboawater.com
Specifications subject to change without notice.

How can I see the M8 Cycle Time? (spaTouch™ 3)

Go to the *Home* screen (A) on the spaTouch™ 3 panel, and navigate to the *System Information* screen (B) to view the *M8 Cycle Time* (C). Press the Up/Down buttons (D) to scroll the System Information list. If M8 is turned Off, the *M8 Cycle Time* says "Disabled" on the System Information screen, and is always 30 minutes. If M8 is turned On, the *M8 Cycle Time* will be one of the following durations: 30, 60, 90 or 120 minutes. It will display as "--" if the M8 Cycle Time is not applicable (for example, in Rest Mode).



M8

©2020 Balboa Water Group. Single Source Solution. All rights reserved.
3030 Airway Avenue | Costa Mesa, CA 92626 | p 714.384.0384 | www.balboawater.com
Specifications subject to change without notice.

How do I turn M8 On/Off? (spaTouch™ 1 & 2)

Go to the *Home* screen (A) on the spaTouch™ panel and navigate to the *M8* screen (B). Press anywhere in the gray bar (C) to turn *M8* On or Off.

M8 On/Off (TP400, TP500, TP600 Panels)

M8 On/Off is not available when using Simplified Menus on the TP600, TP500 and TP400 panels shown below. When using Full Menus, M8 On/Off is within the Preferences (PREF) menu.



TP600 Panel



TP500 Panel



TP400 Panel

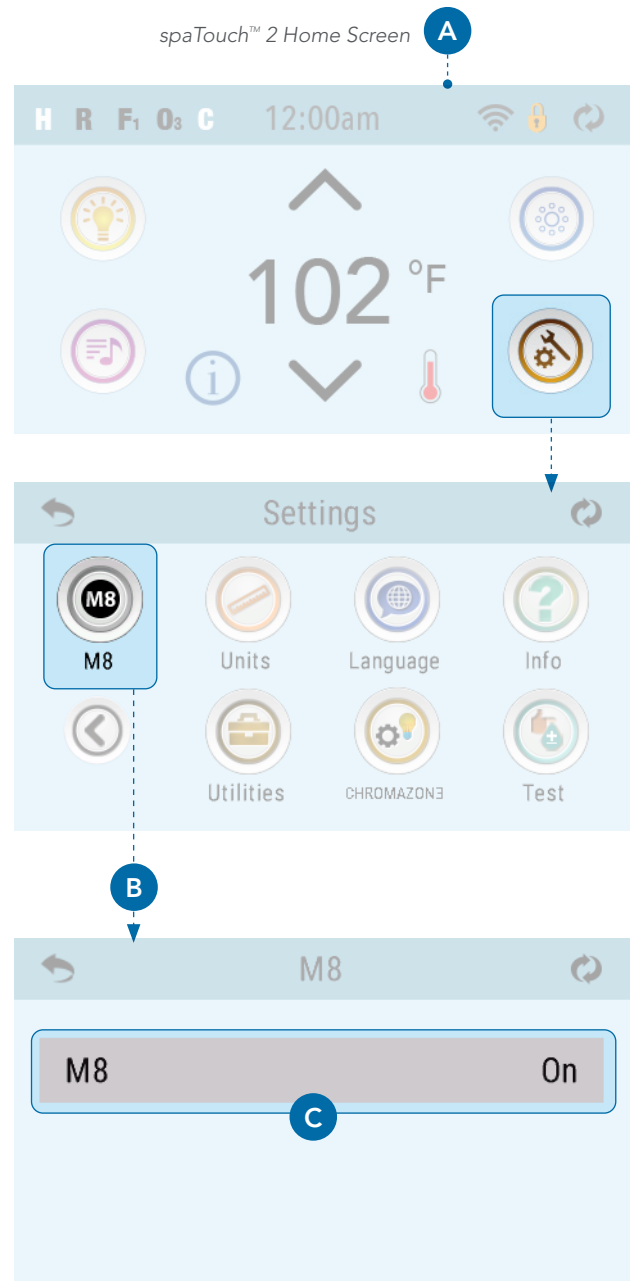

M8

©2020 Balboa Water Group. Single Source Solution. All rights reserved.
3030 Airway Avenue | Costa Mesa, CA 92626 | p 714.384.0384 | www.balboawater.com
Specifications subject to change without notice.

How do I turn M8 On/Off? (spaTouch™ 3)

Go to the *Home* screen (A) on the spaTouch™ 3 panel and navigate to the *Heat Settings* screen (B). Press this button (C) to turn M8 On or Off.

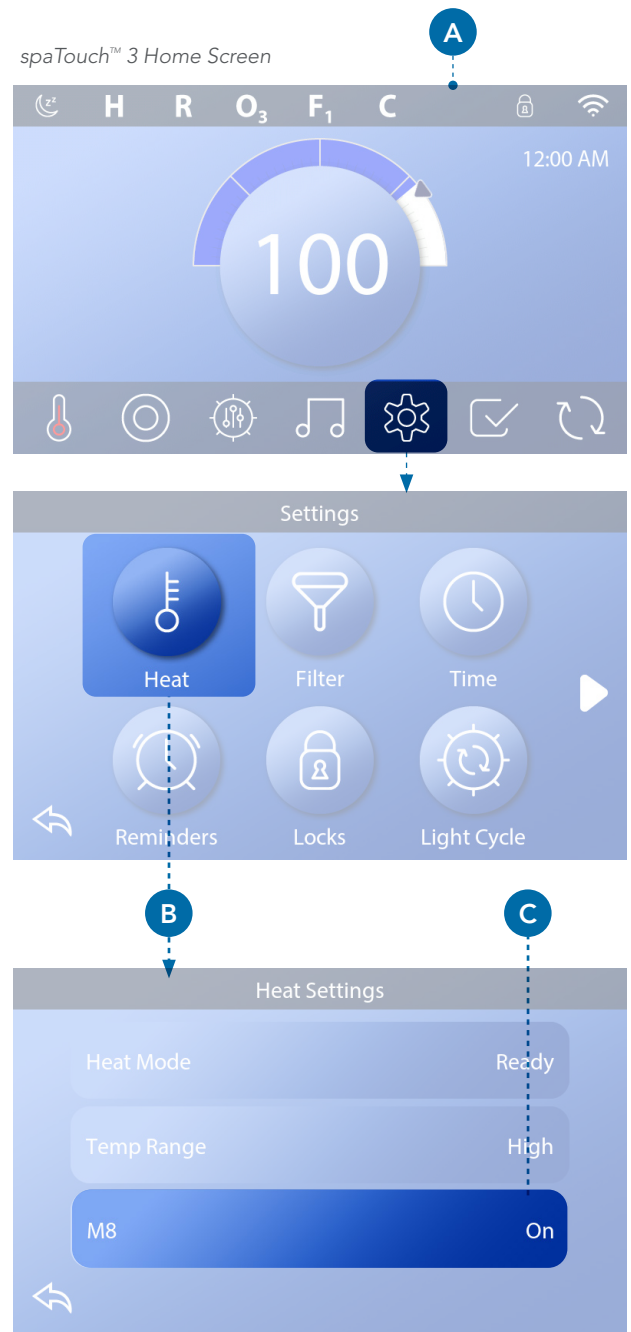

M8

©2020 Balboa Water Group. Single Source Solution. All rights reserved.
3030 Airway Avenue | Costa Mesa, CA 92626 | p 714.384.0384 | www.balboawater.com
Specifications subject to change without notice.



FOR MORE INFORMATION

Visit us online at www.balboawatergroup.com/m8

M8

©2020 Balboa Water Group. Single Source Solution. All rights reserved.
3030 Airway Avenue | Costa Mesa, CA 92626 | p 714.384.0384 | www.balboawater.com
Specifications subject to change without notice.

BALBOA
water group